



*E. M. Webb*  
16. 2. 95



Copy

Grant under the 4th & 6th  
clauses of "The Confiscated  
Lands Act, 1867"

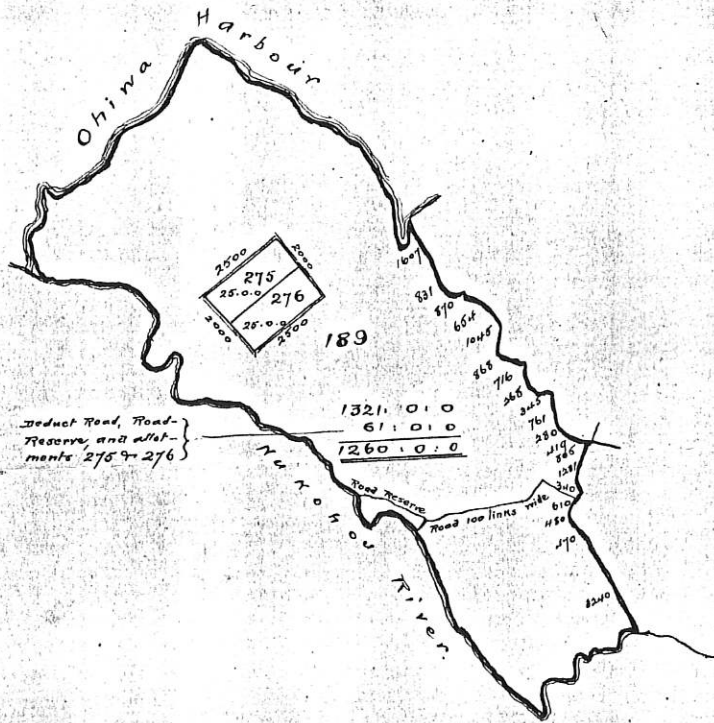

Scale: 40 chains to an Inch

Surveyed by L. Simpson

Chief-Surveyor: A. Percy Smith / Assistant Surveyor General

Draftsman: E. Morrow

Draw No. 21507

*Copy*

Entered at 10 a.m. o'clock, on the 5th  
day of June, 1886.

*J. J. Dixon*  
District Land Registrar.

Registration District of Auckland

DATED ~~3rd~~ June 1886.  
126 A. 0 R. 0 P.

**GRANT**

To, Teira Haruru, and others

Entered in R. No. 64 fol. 200

*J. A. Cole*  
Commissioner of Crown Lands.

Entered on Record this 11th day of  
June, 1886.

Reg. No. A. 103

Folio 229 } *M. J. B. Shortt*  
Under-Secretary for Crown Lands.